

**BALDOR • RELIANCE**

---

# Customer information packet

## ECR91008TR-4

100HP, 890RPM, 3PH, 60HZ, 445T, TEFC, F1

Class - None

Division - Not Applicable

Copyright © All product information within this document is subject to ABB Motors and Mechanical Inc. copyright © protection, unless otherwise noted.

7/18/2023 4:07:31 AM

## Specifications

|                               |                             |
|-------------------------------|-----------------------------|
| Enclosure                     | TEFC                        |
| Frame                         | 445T                        |
| Frame Material                | Iron                        |
| Frequency                     | 60.00 Hz                    |
| Motor Letter Type             | Three Phase                 |
| Output @ Frequency            | 100.000 HP @ 60 HZ          |
| Phase                         | 3                           |
| Synchronous Speed @ Frequency | 900 RPM @ 60 HZ             |
| Voltage @ Frequency           | 460.0 V @ 60 HZ             |
| XP Class and Group            | None                        |
| XP Division                   | Not Applicable              |
| Agency Approvals              | CSA EEV                     |
| Ambient Temperature           | 40 °C                       |
| Auxillary Box                 | No Auxillary Box            |
| Base Indicator                | Rigid                       |
| Bearing Grease Type           | Mobil SHC 220 (Athens Only) |
| Constant Torque Speed Range   | 15-60                       |
| Current @ Voltage             | 133.000 A @ 460.0 V         |
| Design Code                   | A                           |
| Drip Cover                    | No Drip Cover               |
| Duty Rating                   | CONT                        |
| Efficiency @ 100% Load        | 93.6 %                      |
| Feedback Device               | NO FEEDBACK                 |
| Heater Indicator              | No Heater                   |
| High Voltage Full Load Amps   | 133.0 a                     |
| Insulation Class              | F                           |
| Inverter Code                 | Inverter Ready              |
| KVA Code                      | H                           |
| Lifting Lugs                  | No Lifting Lugs             |
| Max Speed                     | 3000 rpm                    |
| Motor Lead Quantity/Wire Size | 3 @ 1/0 AWG                 |
| Motor Standards               | NEMA                        |

## Part detail

|              |            |
|--------------|------------|
| Revision     | E          |
| Type         | AC         |
| Mech. spec.  |            |
| Base         |            |
| Status       | PRD/A      |
| Elec. spec.  | A44WG5226  |
| Layout       | 617427-315 |
| Eff. date    | 10-29-2020 |
| CD Diagram   | 416820-036 |
| Poles        | 08         |
| Leads        | 3#1/0      |
| Proprietary  | False      |
| Created date | 05-07-2015 |

|                                 |                    |
|---------------------------------|--------------------|
| <b>Motor Type</b>               | A4490M             |
| <b>Mounting Arrangement</b>     | F1                 |
| <b>Number of Poles</b>          | 8                  |
| <b>Overall Length</b>           | 44.75 IN           |
| <b>Power Factor</b>             | 75                 |
| <b>Product Family</b>           | Crusher / Chipper  |
| <b>Pulley End Bearing Type</b>  | Roller             |
| <b>Pulley Face Code</b>         | Standard           |
| <b>Service Factor</b>           | 1.25               |
| <b>Shaft Ground Indicator</b>   | No Shaft Grounding |
| <b>Shaft Rotation</b>           | Reversible         |
| <b>Shaft Slinger Indicator</b>  | Shaft Slinger      |
| <b>Speed</b>                    | 890 rpm            |
| <b>Speed Code</b>               | Single Speed       |
| <b>Starting Method</b>          | Direct on line     |
| <b>Thermal Device - Bearing</b> | None               |
| <b>Thermal Device - Winding</b> | None               |

**Nameplate**

**000613007PV**

|                      |                   |                        |          |                     |                            |               |             |             |                    |   |
|----------------------|-------------------|------------------------|----------|---------------------|----------------------------|---------------|-------------|-------------|--------------------|---|
| <b>CAT NO</b>        | ECR91008TR-4      | <b>SPEC NO.</b>        | P44G1825 |                     |                            |               |             |             |                    |   |
| <b>HP</b>            | 100               | <b>AMPS</b>            | 133      | <b>VOLTS</b>        | 460                        | <b>DESIGN</b> | A           |             |                    |   |
| <b>RPM</b>           | 890               | <b>RPM MAX</b>         | 3000     | <b>HZ</b>           | 60                         | <b>AMB</b>    | 40          | <b>SF</b>   | 1.25               |   |
| <b>D.E. BRG.DATA</b> | NU222             | <b>O.D.E. BRG.DATA</b> | 6318     |                     | <b>PH</b>                  | 3             | <b>DUTY</b> | CONT        | <b>INSUL.CLASS</b> | F |
| <b>FRAME</b>         | 445T              | <b>I.P.</b>            | 55       | <b>TYPE</b>         | P                          | <b>ENCL</b>   | TEFC        | <b>CODE</b> | H                  |   |
| <b>POWER FACTOR</b>  | 75                | <b>3/4 LOAD EFF.</b>   | 93.7     |                     | <b>NEMA NOM EFFICIENCY</b> | 93.6          |             |             |                    |   |
|                      | SFA 164           |                        |          |                     |                            |               |             |             |                    |   |
| <b>CHP HZ</b>        | 60-90             | <b>CT HZ</b>           | 15-60    | <b>VT HZ</b>        | 6-60                       |               |             |             |                    |   |
| <b>SER.NO.</b>       |                   |                        |          | <b>MOTOR WEIGHT</b> | 2150                       |               |             |             |                    |   |
|                      | 1.25 SF AMPS =164 |                        |          |                     |                            |               |             |             |                    |   |

---

**NP2496L**

---

MOBIL SHC -220 GREASE

---









**DUTY MASTER ALTERNATING CURRENT MOTORS**  
SQUIRREL-CAGE INDUCTION

617427-315

ENCLOSURE: TOTALLY ENCLOSED

MOUNTING: FOOT

FRAMES G445T/444T

COOLING: FAN COOLED

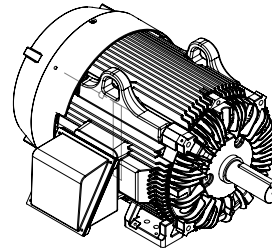
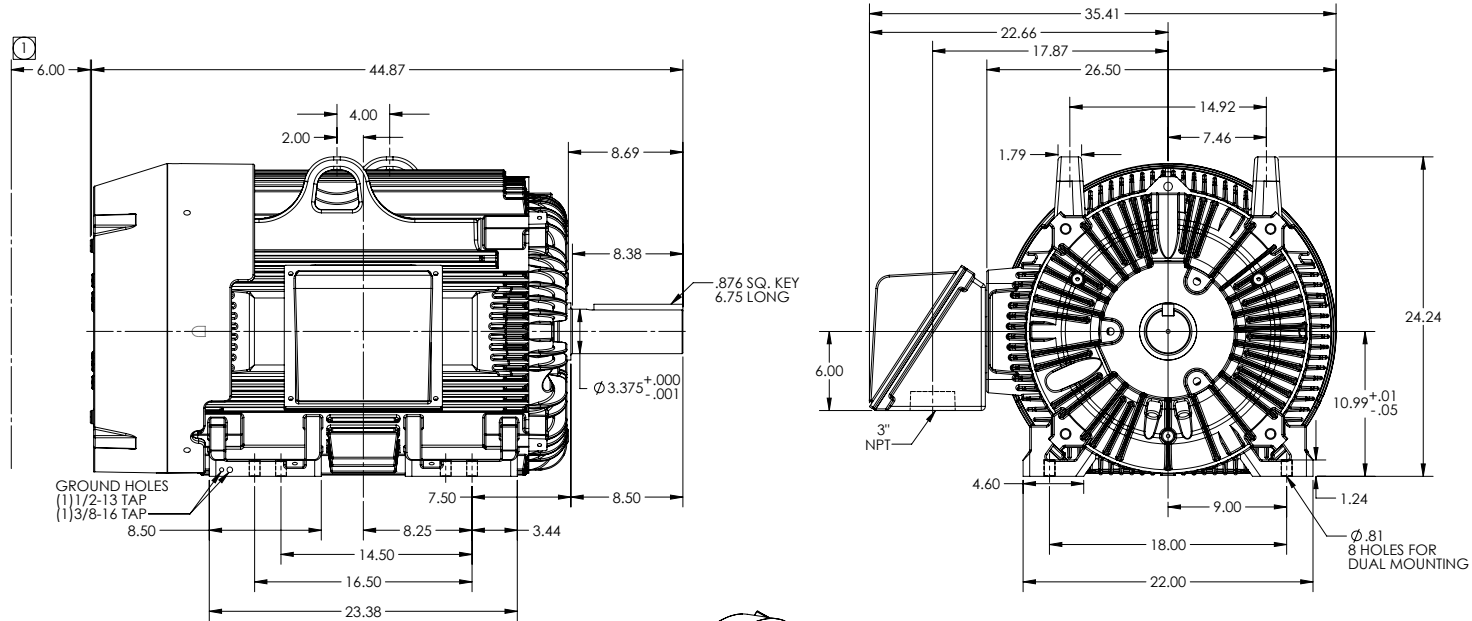

① OBSTRUCTION MUST NOT ENCR OACH ON AIR INLET.  
IF MOUNTING CLEARANCE DETAILS ARE REQUIRED, CONSULT FACTORY.  
MAXIMUM PERMISSIBLE SHAFT RUNOUT WHEN MEASURED AT END OF STANDARD SHAFT EXTENSION IS .003" T.I.R.  
CONDUIT BOX LOCATED ON OPPOSITE SIDE WHEN F-2, W-1, W-4, W-5, W-7, OR C-1 MOUNTING IS SPECIFIED

DIMENSIONS ARE IN INCHES FOR MILLIMETERS SEE SHEET (2)  
CUSTOMER IS RESPONSIBLE FOR DETERMINING THAT MOTOR PERFORMANCE IS SUITABLE IN THE APPLICATION.

SHEET NUMBER  
**1 OF 2**  
617427-315

|                      |             |                              |                  |
|----------------------|-------------|------------------------------|------------------|
| REV. DESC: NEW       | VERSION: 00 | REVISED: 09/06/36 12/05/2014 | TDR: 00000881952 |
| MODEL NO. 617427-315 |             |                              |                  |
| BY: RAGAJH           |             |                              |                  |

**BALDOR**

G445T/444T STD - FOOTED - SIDE/CENTER C.1 C/B ROLLER BRG

617427-315

**DUTY MASTER ALTERNATING CURRENT MOTORS**  
 SQUIRREL-CAGE INDUCTION

617427-315

ENCLOSURE: TOTALLY ENCLOSED

MOUNTING: FOOT

FRAMES G445T/444T

COOLING: FAN COOLED

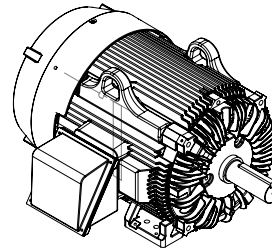
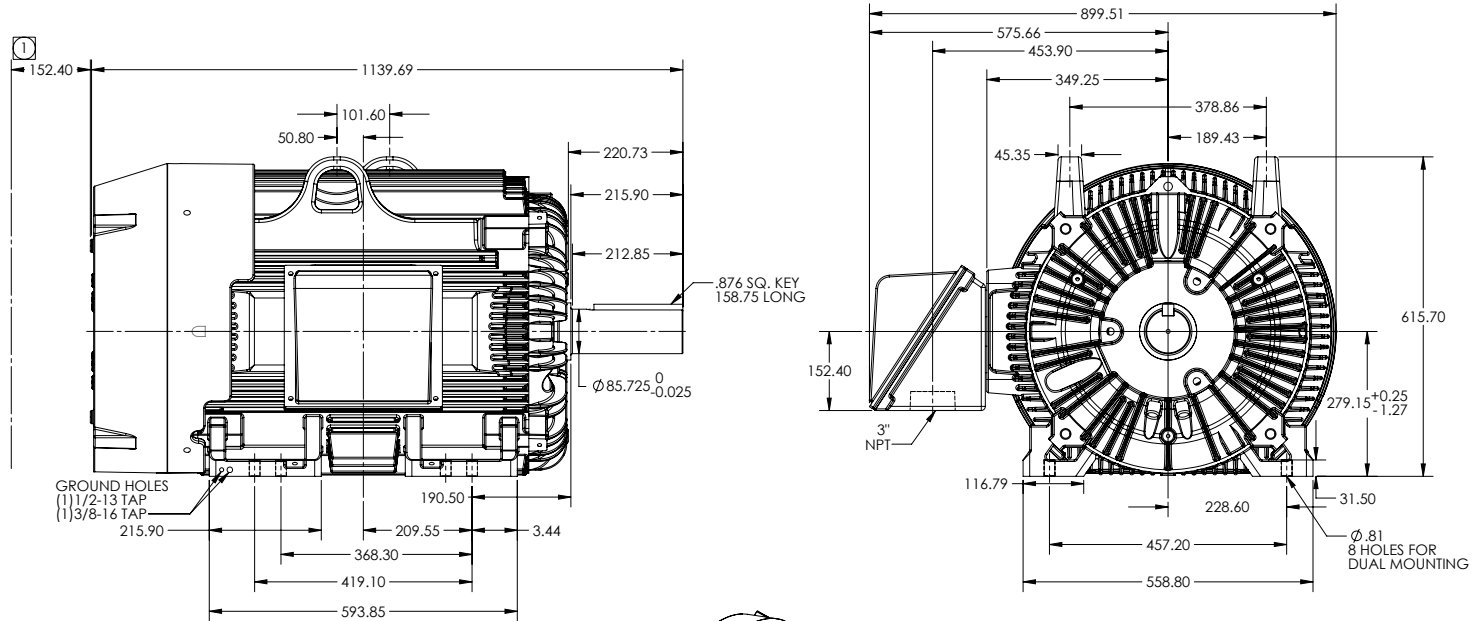

① OBSTRUCTION MUST NOT ENCR OACH ON AIR INLET.  
 IF MOUNTING CLEARANCE DETAILS ARE REQUIRED, CONSULT FACTORY.  
 MAXIMUM PERMISSIBLE SHAFT RUNOUT WHEN MEASURED AT END OF  
 STANDARD SHAFT EXTENSION IS .08 T.I.R.  
 CONDUIT BOX LOCATED ON OPPOSITE SIDE WHEN F-2, W-1,  
 W-4, W-5, W-7, OR C-1 MOUNTING IS SPECIFIED

DIMENSIONS ARE IN MILLIMETERS FOR INCHES SEE SHEET 1  
 CUSTOMER IS RESPONSIBLE FOR DETERMINING THAT MOTOR PERFORMANCE IS SUITABLE IN THE APPLICATION.

SHEET NUMBER  
**2 OF 2**  
 617427-315

|                      |             |                              |                   |
|----------------------|-------------|------------------------------|-------------------|
| REV. DESC: NEW       | VERSION: 00 | REVISED: 09/06/36 12/05/2014 | TDR: 000000881952 |
| MODEL NO. 617427-315 |             |                              |                   |
| BY: RAGAJH           |             |                              |                   |

**BALDOR**

G445T/444T STD - FOOTED - SIDE/CENTER C.1 CB ROLLER BRG

617427-315

416820-036

A-C MOTOR  
CONNECTION DIAGRAM  
STANDARD 3 LEAD CONNECTED



(N.P. 1575-BA)

416820-036

|                                      |                              |                   |
|--------------------------------------|------------------------------|-------------------|
| REV. DESC: LOADED TO BUS, C/R 335225 |                              |                   |
| REV. LTR: -                          | VERSION: 00                  | TDR: 000000538207 |
| FILE: \MGA\00000\682                 | REVISED: 11:54:06 04/30/2010 |                   |
| MTL: -                               | BY: RAGRA                    |                   |

**BALDOR**

CONN DIAG - STANDARD 3 LEAD  
SH 1 of 1